

SPM 20 sound projector

①

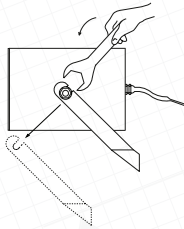

Remove mounting bracket from loudspeaker.

②

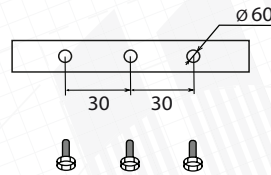

Drill holes according the drawing. Fix loudspeakers bracket on the wall with fasteners suitable for your wall type.

③

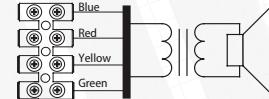

Wire color	Power taps
Blue	COM
Red	20 W
Yellow	10 W
Green	5 W

Connect speaker to 100V audio line via block terminal.

④

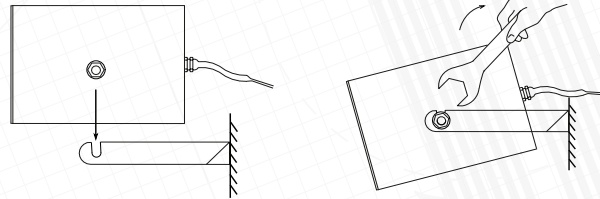

Place loudspeaker in mounting bracket, set necessary corner and tighten screws.

Please pay attention: Mount the loudspeaker on the reliable base only.